

REV.	DESCRIPTION	DRAWN	CHECKED	APPROVED

Material:

- 1, Base: UL94V-0 PBT thermoplastic, Color: Black
- 2, Cover: UL94V-0 PBT thermoplastic, Color: red, Black, blue
- 3, Push button: engineering plastics, white
- 4, Terminal: Copper Alloy with gold plating.

Mechanical:

- 1, operation force: 0.2kgf max
- 2, stroke: 2.00mm
- 3, operation temperature: -20 ℃ to 70 ℃
- 4, storage temperature: -40 ℃ to 85 ℃

Electrical:

- 1, electrical life: test under voltage 24VDC and current 25mA each switch, toggle back and forth 2000 times.
- 2 of rated current, switch does not often switch: 100mA, voltage 50VDC.
- 3 of rated current, switch switch: 25mA, voltage 24VDC.
- 4, the contact impedance (A: initial value of the maximum 50m Ω, B testing after the maximum 100m
- 5, insulation resistance: the minimum 100M Ω, 500VDC
- 6, the compressive strength: 500VAC/1 minutes.
- 7, interelectrode capacitance: Max 5pF.
- 8, the loop: single contact single selection

Soldering and cleaning process:

- 1, in all the operation process, please ensure that the switch in the "off" position.
- 2, wave soldering: recommended soldering temperature at 500 ℃ F (260 ℃), max 5 seconds.
- 3, hand welding: use 30 watt iron control temperature at 608 ℃ F (320 ℃), the welding time is about 2 seconds.
- 4, cleaning: cleaning process using ultrasonic method, can give better results, use steam mode, the temperature can not be more than 125℃ F (51℃).

Packing: the above products are all in IC tube packaging, to ensure that the quality of a good, 28pcs/ pipe, 1344pcs/48 pipe / box, 8 boxes to a carton, carton specifications 52.5\*29\*49CM.

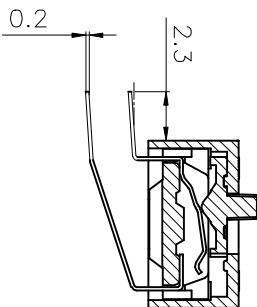
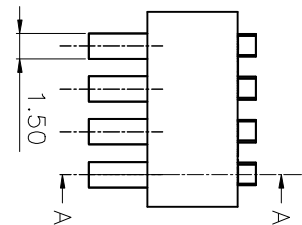
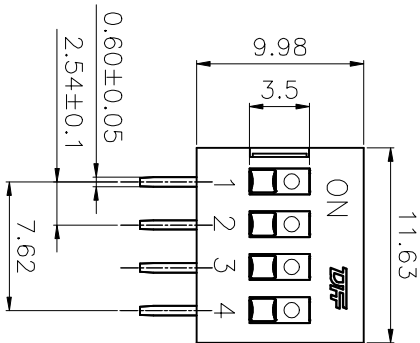

SECTION A-A

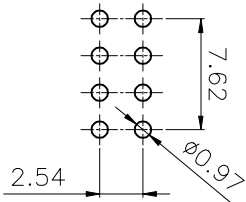

P.C.B LAYOUT

GENERAL TOLERANCE		ANGLE TOLERANCE		PROJECTION		TITLE	
X.	±0.30	X.	±2°	UNITS	mm	KF1003-2.54-4P	
.X	±0.15	.X	±1°	SHEET SIZE	A4	SERIES	
.XX	±0.10	.XX	±0.5°	KAIFENG ELECTRONIC		KF1003	
DRAWING TYPE	CUSTOMER	DRAWING NO.	1:1	SHEET	1 OF 1	KAIFENG ELECTRONIC CO.,LTD	

慈溪市凯峰电子有限公司

KAIFENG ELECTRONIC

KAIFENG ELECTRONIC CO.,LTD